

# 2026 Ohio State Leadership Conference Advisor Guide

February 23-24, 2026  
Columbus, Ohio



## WELCOME

The Business Professionals of America, Ohio Association, State Leadership Conference brings together competitors, business and industry partners, advisors, and vendors to provide an opportunity for Ohio career-technical education students to showcase their development of leadership skills and career-related competencies. The State Leadership Conference (SLC) is the highlight of the Ohio Association year and helps more than 2,300 members accomplish these objectives. The Workplace Skills Assessment Program (WSAP) events, state officer elections, Torch Award Ceremony, and evening entertainment are highlights of the conference.

During State Leadership Conference, attendees will:

- Compete in state-level Workplace Skills Assessment Program (WSAP) competitive events;
- Attend sessions designed to develop leadership and team building skills;
- Build a network by connecting with members and professionals from around the state of Ohio;
- Strengthen their professional and technical skills; and,
- Experience Columbus, Ohio!

## HEALTH AND SAFETY GUIDELINES

**Health and safety are paramount.** Ohio BPA considers the health and safety of all who attend the State Leadership Conference, including our attendees, staff, partners, volunteers and on-site vendors/service providers, as our top priority.

## CONFERENCE PROGRAMMING

### Conference Programming

The Ohio BPA SLC Schedule of Events is listed on the Ohio BPA Website and a detailed posting will be outside of Regency Ballroom and Union Meeting Room on day of event.

- [State Leadership Conference - Ohio BPA State Association](#)

## STATE LEADERSHIP CONFERENCE AT-A-GLANCE

### Sunday, February 22

Time	Activity
<b>4:00p-4:50p</b> <b>Battelle Hall</b>	Rehearsal for State Officers   Casual Attire
<b>6:00p-7:30p</b> <b>Battelle Hall</b>	6:00-7:00   State Officer Candidate Panel Interviews   Campaign Managers set-up Campaign Tables 7:00-7:30   Candidate & Campaign Manager Orientation Meeting Candidates-Professional Attire; Campaign Managers- Business Casual or Prof Attire

### Monday, February 23

Time	Activity
<b>8:30a-11:00a</b>	Registration Packet & Conference T-shirt Pick-Up by advisors ➔ Foyer outside of Regency Ballroom & Battelle Hall
<b>9:00a-5:00p</b>	Some contests to begin at 9:00am   Optional selection during registration Competitive Events   Judged-Prof Attire; Computer Events-Prof or Bus Casual All ML/PS ➔ 9:00a-1:00p
<b>11:00a-6:00p</b>	Grading Room ➔ All Graders arrive 15min after end of contest time ➔ Time slot will be given during registration process ➔ Bring a laptop/device – Pens & Calculators will be supplied
<b>1:00p-2:50p</b>	1:00-1:20   Meet the Candidates 1:25-2:25   State Officer Candidate Speeches 2:30-2:50   Voting Delegate Session Candidates-Professional Attire; Delegates/Audience-Business Casual or Prof Attire
<b>3:00p</b>	Hotel Check-In
<b>1:30-4:30</b>	On-Site Open Event Testing for Secondary Level   ML/PS – 10:00-1:00

<b>4:00p-5:00p</b> <b>Battelle Hall</b>	Middle Level & Post-Secondary Grand Awards Ceremony ➔ Professional attire required to go on stage.
<b>8:00p-9:00p</b>	Torch Awards Ceremony   SLC T-Shirt and/or Business Casual
<b>9:30p-10:30p</b>	ThinkFast Interactive – Evening Entertainment   SLC T-Shirt & Casual Attire
<b>11:00p</b>	Curfew
<b>Tuesday, March 11, 2025</b>	
<b>Time</b>	<b>Activity</b>
<b>9:20a</b>	Doors Open to Grand Awards Ceremony
<b>9:50a-12:00p</b>	Grand Awards Ceremony ➔ Professional attire required to go on stage.

## Hyatt Regency Map

### MEETING ROOMS FIRST FLOOR

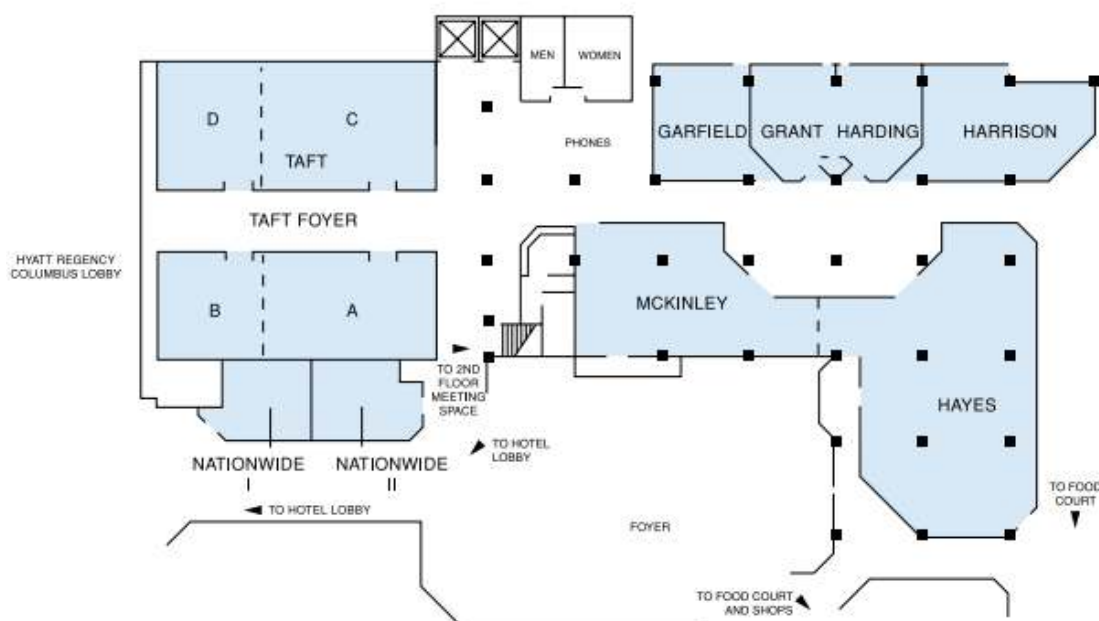

## MEETING ROOMS SECOND FLOOR

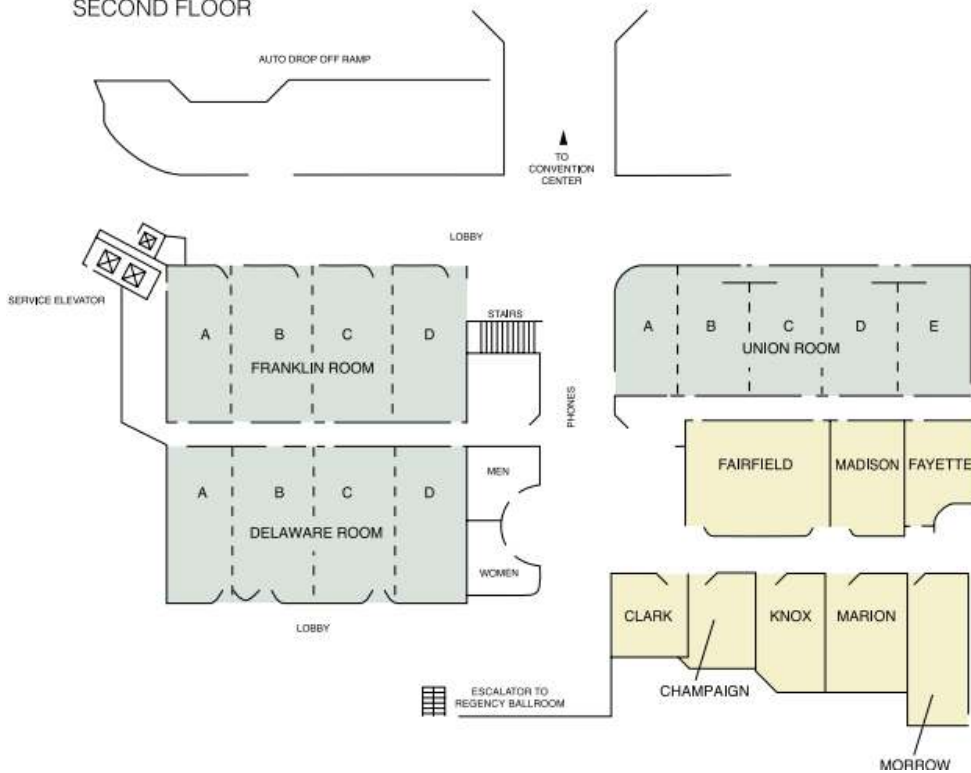

## REGENCY BALLROOM AND EXHIBIT ROOM THIRD FLOOR

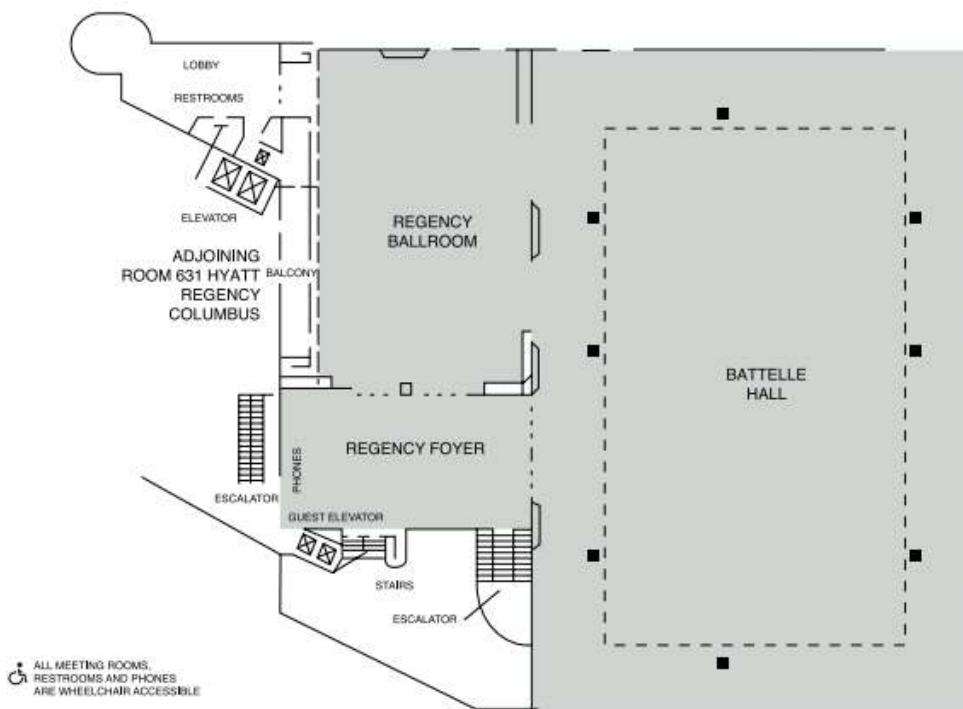

## On-Site Event Testing

Regency Ballroom & Union A/B Meeting Rooms: Judged Events -- 9:00am-5:00pm

Franklin Rooms & Delaware Rooms: Computer labs for Written Events -- 9:00am-4:00pm

→ Open Events objective tests from 1:30pm-4:30pm, ML/PS from 10:00-1:00.

## State Officer and Delegates Session

On Monday, 12 state officer candidates will present their campaign speeches.

→ All members are encouraged to attend and listen.

Voting Delegates: Each Ohio Association chapter may select up to five (5) students to attend SLC to serve as voting delegates. Competing in an SLC event is not required.

Students designated as voting delegates must be officially registered in that role (*even if they are also competing*) and are required to attend all election-related sessions and events. Delegate votes represent their chapter, therefore, attendance by all chapter members is highly encouraged. There will be time for them to discuss who to vote for.

## Torch Awards Ceremony

Battelle Hall: Since, ceremony ends close in time to the evening entertainment, attendees GOING on stage may wear their SLC T-shirts with Business Casual pants/skirt or just Business Casual Attire. All others may wear their SLC T-shirts with casual attire.

## Grand Awards Ceremony Live Stream

The Grand Awards Ceremony on Tuesday morning will be live-streamed. The viewing link will be shared on Instagram (@ohiobpa) and sent directly to advisors via email.

## Monday Evening Activity: ThinkFast Interactive

The Ohio Association State Officers welcome all members to ThinkFast Interactive, a highly interactive and visually stimulating event that includes multiple-choice trivia and participant polling questions related to age-relevant academic and pop culture trivia about topics such as music, TV, movies, art, literature, science, math, geography, history, and pop icons. Check out their website: [Home - ThinkFast Interactive](#)

Come to enjoy the show or choose to compete for a chance to win prizes and Gift Cards! The Showdown will take place Monday evening from 9:30pm-10:30pm.

→ Wear your SLC T-Shirts!!

# REGISTRATION INFORMATION

## Registration Fees

Registration fees for the 2025 Ohio BPA SLC include:

- a SLC T-shirt
- ThinkFast Interactive evening activity
- Meeting room rentals
- All materials, awards, production, and other costs associated with conference

Description	Rate if registered by 1/30/26	Late Rates for registration 2/2/26-2/6/26
Students, Advisors and Chaperones	\$80.00	\$100.00
State Officer Candidates, Campaign Managers and Voting Delegates*	\$80.00	\$100.00
CEAC Member (State or National)	\$0.00	\$0.00
Administrators/Bus Drivers	\$0.00	\$0.00
Current State Officers	\$0.00	\$0.00

*\*State officer candidates, campaign managers and voting delegates, **even if they are also competing**, must be registered as a candidate, campaign manager or voting delegate for planning purposes. Voting delegates can be switched at SLC.*

## Registration Procedure

All students, advisors and chaperones attending the conference are required to register for the conference using the [online registration system](#)

➔ Link will not work until registration officially opens.

## Conflicts

Ohio BPA understands that members may face uncontrollable circumstances such as weather, school transportation issues, or testing conflicts. To assist with these situations, a **Conflict Room** will be available in **Delaware C from 12:00 PM to 3:00 PM**. If any of

these conflicts affect your scheduled test time, please report to Delaware C, and we will do our best to accommodate you.

Ohio BPA acknowledges that its members are active leaders and students with many responsibilities. While schedule/name change requests for competitive events are not guaranteed, Ohio BPA will make every effort to accommodate requests submitted before **Friday, February 6, 2025**. Any requests made after this date—including those made during the State Leadership Conference—will be reviewed and **charged a \$25.00 processing fee** per change. Members are encouraged to plan ahead and review all personal, school, and work commitments before confirming their participation in SLC.

## HOTEL INFORMATION

### Hotel Rates | \$220 per room per night

The Ohio Association must meet its contractual obligations to the Hyatt Regency Columbus and Hilton Columbus Downtown before we can book blocks at surrounding hotels. Each room – Single, Double and/or Quad – is \$220/night.

**Hyatt Regency** | 350 N. High Street, Columbus, OH 43215

**Hilton Columbus** | 402 N. High Street, Columbus, OH 43215

Overflow → In such cases that additional housing is necessary, attendees will be placed in overflow hotels near Hyatt Regency.

### Check-In Procedure

Advisors will be responsible for obtaining room keys from the front desk and distributing them to their chapters.

Hotel check-in begins at 3:00pm.

→ Please note...sleeping rooms may not be available upon arrival, so please plan accordingly.

Luggage storage will be available at hotels. **Do not leave items unattended in other areas of the venue.**

### Check-Out Procedure

Check-out is **PRIOR** to the Grand Awards Ceremony on Tuesday Morning.



Luggage storage will be available at hotels. **Do not leave items unattended in other areas of the venue.**

## Damage

Any damage to any property or furnishing in the hotel rooms or venue facilities will be the responsibility of the local chapter advisor and school district.

# PAYMENT INFORMATION

**Payment must be received by February 20, 2026 to avoid late fees.**

Remit payment to:

**Ohio BPA**  
**25 S. Front Street, 6<sup>th</sup> Floor**  
**Columbus, Ohio 43215**

OR – Pay online using a credit card. Ohio BPA will pay the 3% processing fee.

# IMPORTANT REMINDERS

## Judge Recruitment

Business Professionals of America, Ohio Association, is a career-technical student organization that serves over 13,000 members. For the State Leadership Conference to run smoothly, we need judges.

Do you know any professionals interested in judging or grading competitive events? If so, have them sign up here: [Judges and Sponsors - Ohio BPA State Association](#)

- ➔ Receive one (1) registration reimbursement of \$80.00 for every two (2) judges/graders recruited to sign up **AND** fulfill their responsibilities.

**New BPA Advisors!** Don't have student attendees or competitors this year? Volunteer at SLC in exchange for free conference registration – an \$80 value.

- ➔ Contact Tina Krosse at [Tina.Krosse@education.ohio.gov](mailto:Tina.Krosse@education.ohio.gov) if interested.

## Technology at State Leadership Conference

Business Professionals of America, Ohio Association will be hosting on-site computer labs (230 laptops and 90+ iPads) for competitions that require AnswerWrite and JudgePro systems.

Students competing in **programming events** (Java, C++, C#, Python, etc.) are required to bring their own **laptops that are USB/flash drive compatible**.

Students participating in Judged Events, like NLC, are urged to present from their laptop and use the table provided for their presentation. Use of a portable monitor is optional.

## APG Assignment

All advisors are expected to sign up for one shift as a proctor, grader or contest assistant. Position selection is a part of the conference registration process.

## Conduct

The Business Professionals of America Code of Ethics states: "Each individual assumes a number of obligations, one of which defines professional conduct. This Code of Conduct is an extension of the classroom situation. A professional code of conduct is required as would be proper for the classroom. This means that during Business Professionals of America functions, individuals are responsible for maintaining a high professional standard of conduct." Advisors are responsible for the conduct of their students and guests at all times throughout the conference events.

→ **Failure to conduct oneself in the appropriate manner may result in dismissal from SLC and disqualification from attending the NLC.**

## Dress Code

Professional appearance is an important aspect of the overall preparation of Ohio members for the business world.

- Professional Attire: Judged events, awards ceremony, and going on stage
- Business Casual Attire: Computer tests, workshops, and Torch Ceremony
- Casual Attire: Worn outside of the above activities -- school appropriate
  - Wear your SLC T-shirt to ThinkFast Entertainment on Monday evening.

## Non-Discrimination Policy

Ohio BPA is committed to creating and maintaining a healthy and respectful environment for all attendees. Any behavior in the form of discrimination, harassment or bullying will not be tolerated. It is the responsibility of all attendees to uphold and contribute to this climate.

## THINGS TO DO IN COLUMBUS

### North Market | Central Ohio's Public Market

North Market is a 145-year-old vibrant public market made up of Ohio's best independent merchants, farmers, and makers. <https://northmarket.org/>

### Ohio Statehouse Tours | Capitol Square

Guided tours are available every day, except on state holidays. Please call 614-728-3726 to schedule a tour for groups of more than 10 people. [The Ohio Statehouse](#)

### COSI | Center of Science and Industry

COSI is a nationally esteemed science center that has delighted Central Ohio with all things science for 58 years. For groups of 12+: \$10.50 per person, all teachers have free entry. The Titanic exhibit will also be happening at this time and would be an additional \$10 to attend. COSI recommends calling in early February to schedule your visit. [School Field Trips - COSI](#)

### National Veterans Memorial and Museum | E. Broad Street

This museum is the only place where the stories of our veterans, their families and the Fallen – across all branches of service and all eras of conflict – are told together. <https://nationalvmm.org/>

### Easton Town Center

Easton features 200+ best-in-class retailers alongside exciting dining options, Ohio's largest movie theater and pedestrian-friendly open-air town squares, fountains, and parks. <https://eastontowncenter.com/>

### Ohio History Center | Bring History to Life

Visit the Ohio History Center, the state's repository for comprehensive collections of materials in the fields of history, prehistory and natural history. It also houses the state's archives and historical library. <https://www.ohiohistory.org/education/field-trips/>

### Buca di Beppo Columbus | Arena District

In the spirit of Italian culture, our group menus are served family-style, meant to be shared and feature our large Buca di Beppo portions! Our fun and festive semi-private dining rooms are uniquely decorated making Buca the perfect place for hosting your banquet or gathering. Contact Anne Anderson for reservations, carryout options and questions: [aanderson@earlenterprise.com](mailto:aanderson@earlenterprise.com) or 614-821-0196

# DRESS CODE GUIDE

This guide provides acceptable and unacceptable dress examples that apply to BPA national events. State associations may define their own dress code policies to use at regional or state-level events.

## Business Professional Dress

Attire for all judged competitive events and to go on stage during any general sessions:

- Suit jackets, blazers, or dresses
- Tops: Dress shirts with ties or blouses
- Bottoms: Dress pants or skirts
- Shoes: Close-toed dress shoes, heels, or flats



## Business Casual Dress

Attire for competitive events inside all computer labs (i.e., open events lab, certification labs, etc.), leadership development workshops, campaign rallies, caucuses, exhibit halls, and general sessions, if not going on stage:

- Tops: Polos, oxford shirts, sweaters, dresses or blouses
  - Sleeveless shirts should be worn with a cover-up, such as a blazer or sweater
- Bottoms: Dress pants or skirts
- Shoes: Dress shoes, heels, or flats



## Casual Dress

Attire for tours, special events, and service activities:

- Tops: T-shirts, sweatshirts, and other casual tops
- Bottoms: Jeans, shorts, or other casual bottoms
- Shoes: Any footwear, including sneakers or sandals



## Additional Notes

- All attire must not include any offensive graphics or slogans.
- All shirts should cover the midriff.

## UNACCEPTABLE ITEMS

The following items are prohibited in all conference areas:

- Strapless, spaghetti straps, tube tops, halter tops, and midriff tops
- Spandex, lycra, or transparent clothing
- Cut-offs and clothing with rips or tears
- Clothing with inappropriate words and pictures
- Mini/short skirts or dresses more than 2' above the knee
- Swimwear



Members who are uncertain about unacceptable attire should ask their chapter advisor, state leader, or any of the BPA conference staff.